

# SUBMITTAL DATA SHEET



Series Name: **Mini Split 25seer Series**

Model Number: **AO25-24N1-M1H / AW25-24N1-M1**

Wall Mounted Heat Pump System	
Location: _____	Approval: _____
Engineer: _____	Date: _____
Submitted to: _____	Construction: _____
Submitted by: _____	Unit #: _____
Reference: _____	Drawing #: _____



INDOOR SPECIFICATION	
Indoor Air Flow (H/M/L) (CFM)	761/601/459
Indoor Noise Level (H/M/L) (dBA)	46.5/44/35
Dimension (WxDxH)	inch 42-5/8 x 9-1/4 x 13-1/4
	mm 1082 x 234 x 337
Package (WxDxH)	inch 45-1/2 x 16-3/8 x 12-3/8
	mm 1155 x 415 x 315
Net/Gross Weight	lbs 30/38
	kg 13.6/17.3

OUTDOOR SPECIFICATION	
Compressor Type	Twin-ROTARY
Refrigerant	R410A
Factory Charge	620ml
Refrigerant Oil	VG74
Outdoor Air Flow (Max) (CFM)	2235
Outdoor Noise Level (dBA)	62.5
Dimension (WxDxH)	inch 37-1/4 x 16-1/8 x 31-7/8
	mm 946 x 410 x 810
Package (WxDxH)	inch 42-7/8 x 19-5/8 x 34-7/8
	mm 1090 x 500 x 885
Net/Gross Weight	lbs 134/144
	kg 61/65.5

EFFICIENCY			
Cooling		Heating	
<b>SEER2</b>	22.3	<b>HSPF2-4</b>	10.3
<b>EER2</b>	12.5	<b>COP</b>	3.0
PERFORMANCE of Cooling			
Cooling (Btu/hr)			
<b>Rated Capacity</b>	23000		
<b>Min/Max Capacity</b>	4650~26600		
<b>Moisture Removal</b>	2.43 L/H (5.1pint/H)		
<b>Standard Operating Range</b>	-22°F~-122°F (-30°C~50°C)		
Rated Cooling Conditions:		Indoor: 80°F DB/67°F WB	
		Outdoor: 95°F DB/75°F WB	
PERFORMANCE of Heating			
Heating (Btu/hr)			
<b>1. @ 47°F Rated (Min/Max)</b>	26000(9550~27000)		
<b>2. @ 17°F Rated</b>	18900		
<b>3. @ 5°F Max: Capacity / COP</b>	23000 / 1.8		
<b>Standard Operating Range</b>	-22°F~-75°F (-30°C~24°C)		
1. Rated Heating Conditions:		Indoor: 70°F DB/60°F WB	
		Outdoor: 47°F DB/43°F WB	
2. Rated Heating Conditions:		Indoor: 70°F DB/60°F WB	
		Outdoor: 17°F DB/15°F WB	
3. Heating Conditions, Compressor Operating at Max. Frequency		Indoor: 70°F DB/60°F WB	
		Outdoor: 5°F DB/5°F WB	

ELECTRICAL	
Power Supply	208/230V, 1Ph, 60Hz
System MCA	25
Connection Wiring	AWG 14-4
System MOCP	35
Compressor RLA	17.1
Outdoor Fan Motor RLA	0.5
Outdoor Fan Motor W	120
Indoor Fan Motor RLA	0.4
Indoor Fan Motor W	58
System Power Input @ Cooling (W)	1840(484~2540)
System Power Input @ Heating (W)	2540(810~3090)
MCA: Min. circuit amps (A)	MOCP: Max. over current protection (A)
RLA: Rated load amps (A)	W: Fan motor rated output (W)

PIPING	
Liquid Size	3/8in (9.52mm)
Gas Size	5/8in (15.9mm)
Drain Size	5/8in (15.88mm)
Max. Piping Length	164ft (50m)
Max. Height Difference	82ft (25m)
Max. Pre-charged Length	25ft (7.5m)
Refrigerant Pre-charged Amount	91.71oz (2600g)
Additional Charge of Refrigerant	0.32oz/ft (30g/m)
Connection Method	Flared

## Indoor Unit Dimension

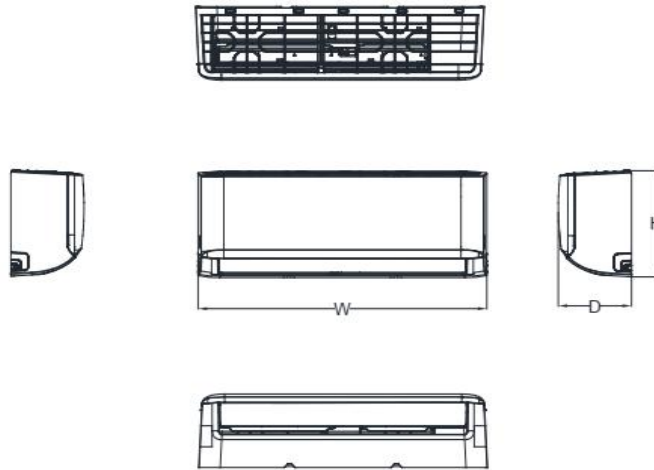

Capacity	Body Code	W(mm/inch)	D(mm/inch)	H(mm/inch)
6K~11K	A	729/28.7	200/7.87	292/11.5
8K~14K	B	802/31.57	200/7.87	295/11.61
12K~21K	C	971/38.23	228/8.98	321/12.64
18K~28K	D	1082/42.6	234/9.21	337/13.27
27K~36K	F	1259/49.57	283/11.14	362/14.25

## Installation Instruction

Refer to the following diagram to ensure proper distance from walls and ceiling:

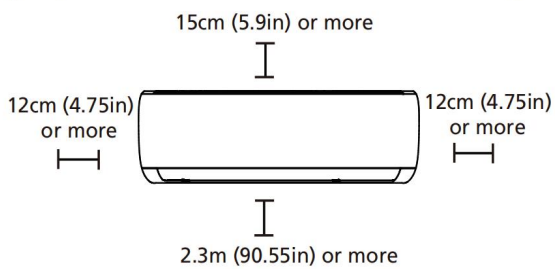

### NOTE ON PIPING ANGLE

Refrigerant piping can exit the indoor unit from four different angles: Left-hand side, Right-hand side, Left rear, Right rear.

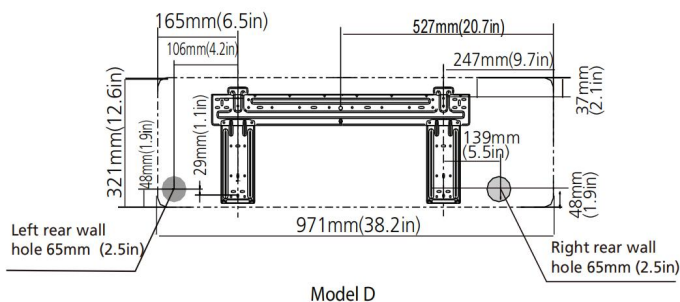
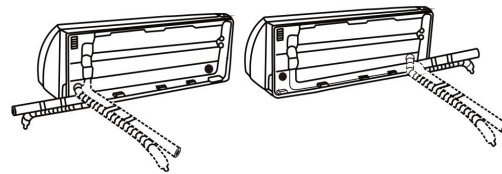

**NOTE:** When the gas side connective pipe is  $\Phi$  16mm (5/8in) or more, the wall hole should be 90mm (3.54in).

### Outdoor Unit Dimension

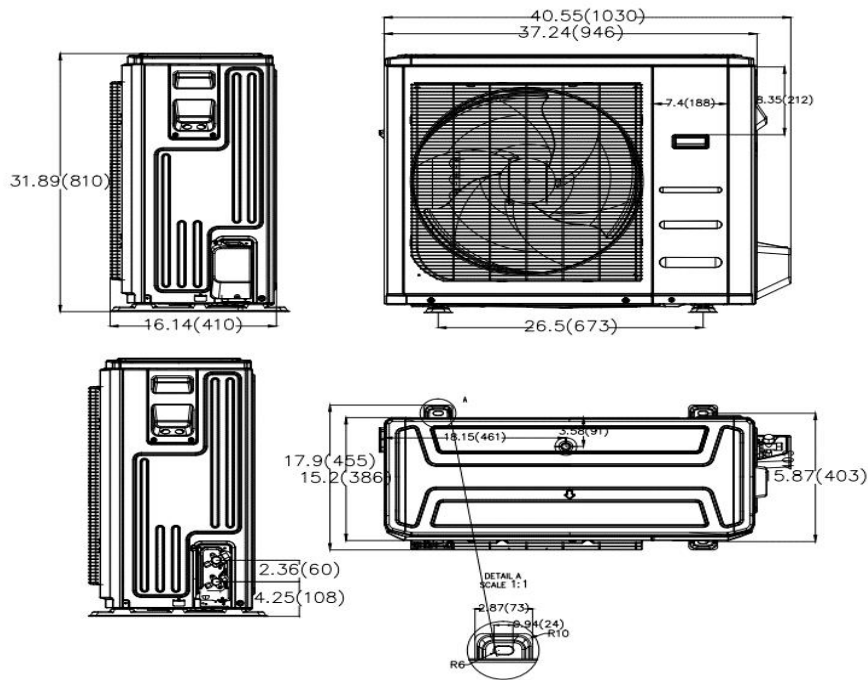

### Installation Instruction

Install the unit by following local codes and regulations, there may be differ slightly between different regions.

