

SUBMITTAL DATA SHEET



Series Name: **Mini Split 25seer Series**

Model Number: **AO25-18N1-M1H / AW25-18N1-M1**

Wall Mounted Heat Pump System	
Location: _____	Approval: _____
Engineer: _____	Date: _____
Submitted to: _____	Construction: _____
Submitted by: _____	Unit #: _____
Reference: _____	Drawing #: _____

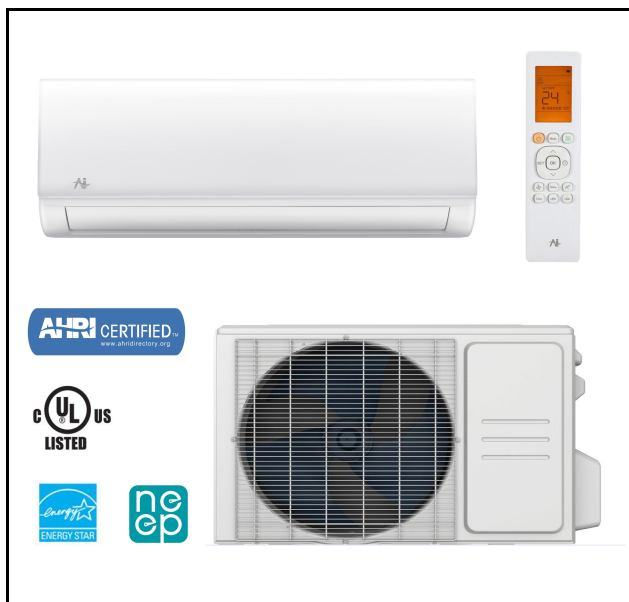

INDOOR SPECIFICATION		
Indoor Air Flow (H/M/L) (CFM)	761/531/459	
Indoor Noise Level (H/M/L) (dBA)	46/40/25	
Dimension (WxDxH)	inch	42-5/8 x 9-1/4 x 13-1/4
	mm	1082 x 234 x 337
Package (WxDxH)	inch	45-1/2 x 16-3/8 x 12-3/8
	mm	1155 x 415 x 315
Net/Gross Weight	lbs	30/37
	kg	13.4/17

OUTDOOR SPECIFICATION		
Compressor Type	Twin-ROTARY	
Refrigerant	R410A	
Factory Charge	620ml	
Refrigerant Oil	VG74	
Outdoor Air Flow (Max) (CFM)	1765	
Outdoor Noise Level (dBA)	58	
Dimension (WxDxH)	inch	35 x 13-1/2 x 26-1/2
	mm	890 x 342 x 673
Package (WxDxH)	inch	39-1/8 x 15-5/8 x 29-1/8
	mm	995 x 398 x 740
Net/Gross Weight	lbs	101/108
	kg	45.8/49

EFFICIENCY			
Cooling		Heating	
SEER2	22.0	HSPF2-4	10.6
EER2	13.0	COP	3.4
PERFORMANCE of Cooling			
Cooling (Btu/hr)			
Rated Capacity	18000		
Min/Max Capacity	8400~20200		
Moisture Removal	1.35 L/H (2.8pint/H)		
Standard Operating Range	-22°F~-122°F (-30°C~50°C)		
Rated Cooling Conditions:		Indoor: 80°F DB/67°F WB	
		Outdoor: 95°F DB/75°F WB	
PERFORMANCE of Heating			
Heating (Btu/hr)			
1. @ 47°F Rated (Min/Max)	18000(6000~23000)		
2. @ 17°F Rated	11100		
3. @ 5°F Max: Capacity / COP	17200 / 1.89		
Standard Operating Range	-22°F~-75°F (-30°C~24°C)		
1. Rated Heating Conditions:		Indoor: 70°F DB/60°F WB	
		Outdoor: 47°F DB/43°F WB	
2. Rated Heating Conditions:		Indoor: 70°F DB/60°F WB	
		Outdoor: 17°F DB/15°F WB	
3. Heating Conditions, Compressor Operating at Max. Frequency		Indoor: 70°F DB/60°F WB	
		Outdoor: 5°F DB/5°F WB	

ELECTRICAL	
Power Supply	208/230V, 1Ph, 60Hz
System MCA	20
Connection Wiring	AWG 14-4
System MOCP	25
Compressor RLA	14.25
Outdoor Fan Motor RLA	0.8
Outdoor Fan Motor W	80
Indoor Fan Motor RLA	0.3
Indoor Fan Motor W	58
System Power Input @ Cooling (W)	1385(360~1860)
System Power Input @ Heating (W)	1575(470~2170)
MCA: Min. circuit amps (A)	MOCP: Max. over current protection (A)
RLA: Rated load amps (A)	W: Fan motor rated output (W)

PIPING	
Liquid Size	1/4in (6.35mm)
Gas Size	1/2in (12.7mm)
Drain Size	5/8in (15.88mm)
Max. Piping Length	98.4ft (30m)
Max. Height Difference	65.6ft (20m)
Max. Pre-charged Length	25ft (7.5m)
Refrigerant Pre-charged Amount	65.26oz (1850g)
Additional Charge of Refrigerant	0.16oz/ft (15g/m)
Connection Method	Flared

Indoor Unit Dimension

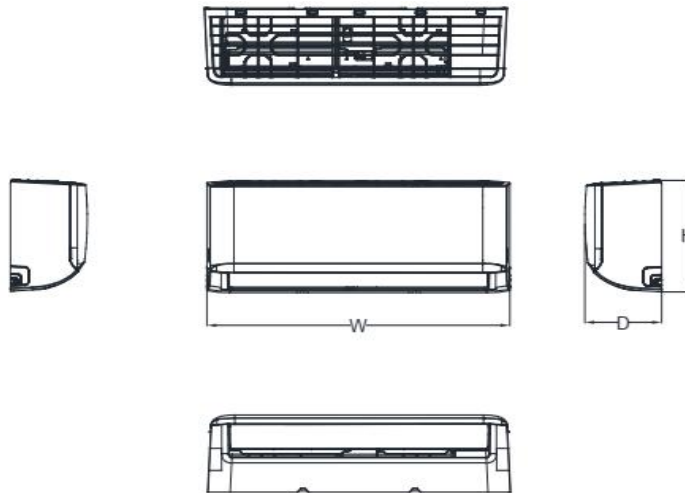

Capacity	Body Code	W(mm/inch)	D(mm/inch)	H(mm/inch)
6K~11K	A	729/28.7	200/7.87	292/11.5
8K~14K	B	802/31.57	200/7.87	295/11.61
12K~21K	C	971/38.23	228/8.98	321/12.64
18K~28K	D	1082/42.6	234/9.21	337/13.27
27K~36K	F	1259/49.57	283/11.14	362/14.25

Installation Instruction

Refer to the following diagram to ensure proper distance from walls and ceiling:

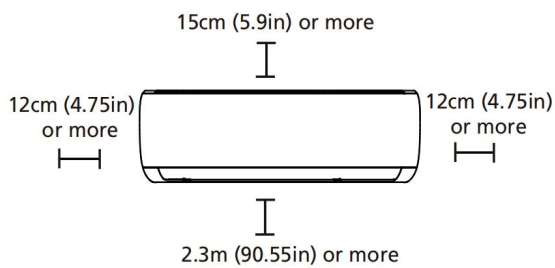

NOTE ON PIPING ANGLE

Refrigerant piping can exit the indoor unit from four different angles: Left-hand side, Right-hand side, Left rear, Right rear.

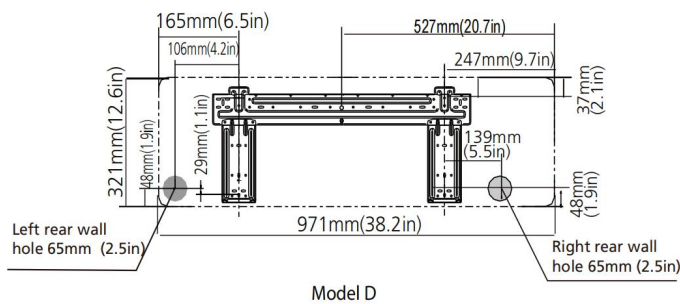
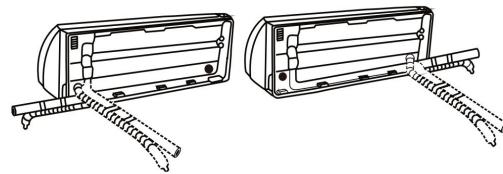

NOTE: When the gas side connective pipe is Φ 16mm (5/8in) or more, the wall hole should be 90mm (3.54in).

Outdoor Unit Dimension

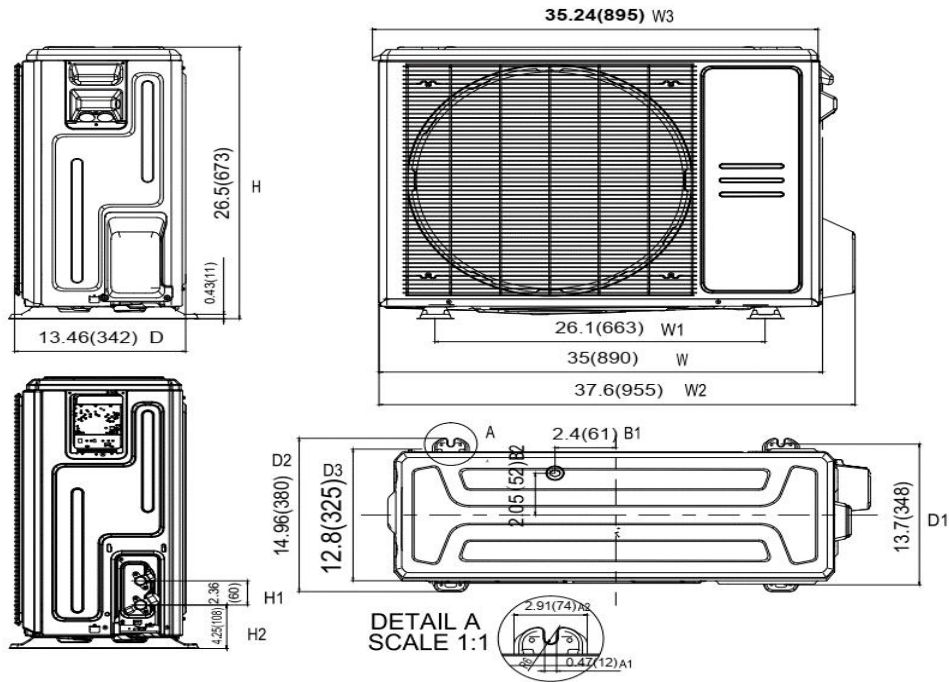

Installation Instruction

Install the unit by following local codes and regulations, there may be differ slightly between different regions.

