

SUBMITTAL DATA SHEET



Series Name: **Mini Split 21seer Series**

Model Number: **AO21-24N1-M1 / AW21-24N1-M1**

Wall Mounted Heat Pump System	
Location: _____	Approval: _____
Engineer: _____	Date: _____
Submitted to: _____	Construction: _____
Submitted by: _____	Unit #: _____
Reference: _____	Drawing #: _____



INDOOR SPECIFICATION		
Indoor Air Flow (H/M/L) (CFM)		546/402/331
Indoor Noise Level (H/M/L) (dBA)		45/39.5/36
Dimension (WxDxH)	inch	42-5/8 x 9-1/4 x 13-1/4
	mm	1082 x 234 x 337
Package (WxDxH)	inch	45-1/2 x 16-3/8 x 12-3/8
	mm	1155 x 415 x 315
Net/Gross Weight	lbs	30/38
	kg	13.6/17.3

OUTDOOR SPECIFICATION		
Compressor Type		Twin-ROTARY
Refrigerant		R410A
Factory Charge		620ml
Refrigerant Oil		VG74
Outdoor Air Flow (Max) (CFM)		1765
Outdoor Noise Level (dBA)		60
Dimension (WxDxH)	inch	35 x 13-1/2 x 26-1/2
	mm	890 x 342 x 673
Package (WxDxH)	inch	39-1/8 x 15-5/8 x 29-1/8
	mm	995 x 398 x 740
Net/Gross Weight	lbs	98/105
	kg	44.4/47.4

EFFICIENCY			
Cooling		Heating	
SEER2	18.5	HSPF2-4	8.6
EER2	9.5	COP	3.0
PERFORMANCE of Cooling			
Cooling (Btu/hr)			
Rated Capacity		24000	
Min/Max Capacity		6200~24600	
Moisture Removal		2.7 L/H (5.7pint/H)	
Standard Operating Range		5°F~122°F (-15°C~50°C)	
Rated Cooling Conditions:		Indoor: 80°F DB/67°F WB Outdoor: 95°F DB/75°F WB	
PERFORMANCE of Heating			
Heating (Btu/hr)			
1. @ 47°F Rated (Min/Max)		24000(6800~26800)	
2. @ 17°F Rated		14500	
3. @ 5°F Max: Capacity / COP		14800 / 1.83	
Standard Operating Range		5°F~75°F (-15°C~24°C)	
1. Rated Heating Conditions:		Indoor: 70°F DB/60°F WB Outdoor: 47°F DB/43°F WB	
2. Rated Heating Conditions:		Indoor: 70°F DB/60°F WB Outdoor: 17°F DB/15°F WB	
3. Heating Conditions, Compressor Operating at Max. Frequency		Indoor: 70°F DB/60°F WB Outdoor: 5°F DB/5°F WB	

ELECTRICAL	
Power Supply	208/230V, 1Ph, 60Hz
System MCA	19
Connection Wiring	AWG 14-4
System MOCP	20
Compressor RLA	14.25
Outdoor Fan Motor RLA	0.8
Outdoor Fan Motor W	80
Indoor Fan Motor RLA	0.5
Indoor Fan Motor W	58
System Power Input @ Cooling (W)	2520(292~2900)
System Power Input @ Heating (W)	2350(437~2900)
MCA: Min. circuit amps (A)	MOCP: Max. over current protection (A)
RLA: Rated load amps (A)	W: Fan motor rated output (W)

PIPING	
Liquid Size	3/8in (9.52mm)
Gas Size	5/8in (15.9mm)
Drain Size	5/8in (15.88mm)
Max. Piping Length	164ft (50m)
Max. Height Difference	82ft (25m)
Max. Pre-charged Length	25ft (7.5m)
Refrigerant Pre-charged Amount	62.79oz (1780g)
Additional Charge of Refrigerant	0.32oz/ft (30g/m)
Connection Method	Flared

Indoor Unit Dimension

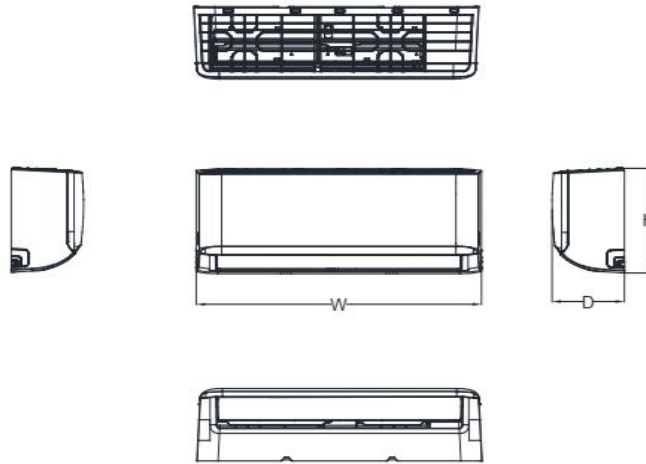

Capacity	Body Code	W(mm/inch)	D(mm/inch)	H(mm/inch)
6K~11K	A	729/28.7	200/7.87	292/11.5
8K~14K	B	802/31.57	200/7.87	295/11.61
12K~21K	C	971/38.23	228/8.98	321/12.64
18K~28K	D	1082/42.6	234/9.21	337/13.27
27K~36K	F	1259/49.57	283/11.14	362/14.25

Installation Instruction

Refer to the following diagram to ensure proper distance from walls and ceiling:

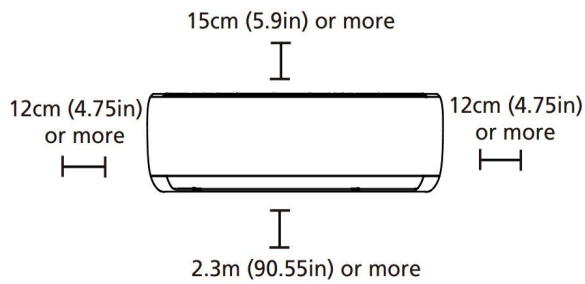

NOTE ON PIPING ANGLE

Refrigerant piping can exit the indoor unit from four different angles: Left-hand side, Right-hand side, Left rear, Right rear.

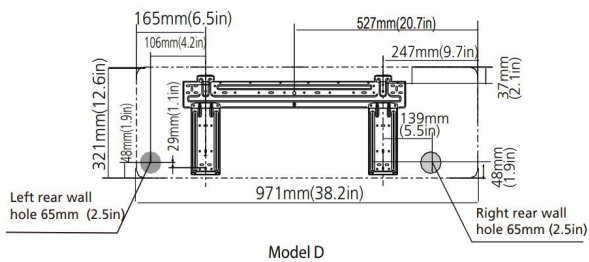
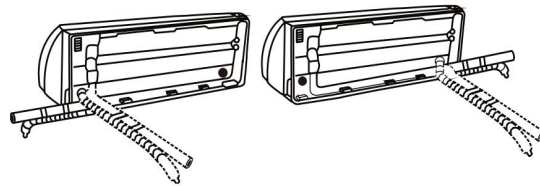

NOTE: When the gas side connective pipe is Φ 16mm (5/8in) or more, the wall hole should be 90mm (3.54in).

Outdoor Unit Dimension

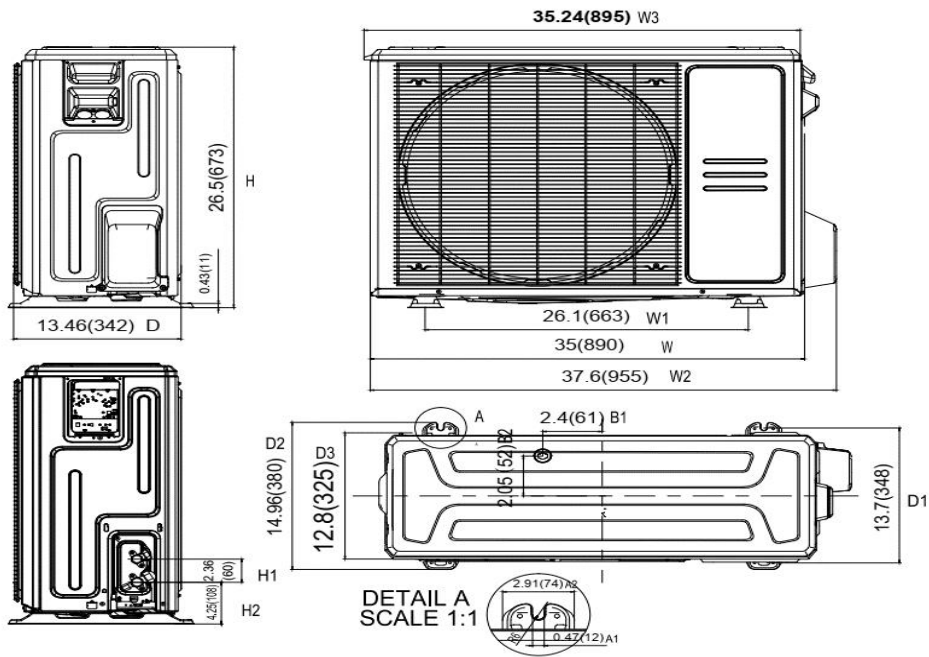

Installation Instruction

Install the unit by following local codes and regulations, there may be differ slightly between different regions.

